

## Double-row taper roller bearing

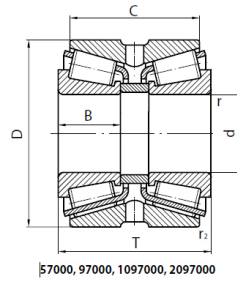

Bearing designation	Dimensions(mm)								Load factor			Load ratings(N)		Limiting rotational speed. min-1		Mass(kg)
	d	D	T	B	C	r <sub>min</sub>	r <sub>2min</sub>	e	Y1	Y2	Y0	Cr	Cor	Grease	Oil	
97506A	30	62	49.625	20	41	1	0.3	0.36	1.85	2.75	1.81	94400	129000	5000	6300	0.661
97606AY	30	72	63.5	27	52	1.5	0.5	0.31	2.14	3.2	2.09	139000	179000	4000	5000	1.22
57707AY	35	80	57	23.3	45	1.5	0.3	0.55	1.24	1.84	1.2	118000	171000	4500	5800	1.267
97509A	45	85	54.625	23	45	1.5	0.5	0.42	1.62	2.42	1.59	148000	214000	4000	5000	1.089
97510A	50	90	54.625	23	45	1.5	0.5	0.42	1.6	2.4	1.57	157000	232000	3200	4000	1.36
97810Л1	50	90	64	28.5	51.3	1.5	0.3	0.31	2.21	3.29	2.16	125000	168000		5700	1.649
97212A	60	110	54	22	44	1.8	0.5	0.4	1.57	2.45	1.55	189000	267000	2300	2900	1.97
97512A1	60	110	64.625	28	55	2	0.5	0.4	1.67	2.5	1.63	237000	357000	2800	3600	2.537
97913A	66.675	110	52.388	26.194	46.038	0.8	0.3	0.43	1.55	2.3	1.52	183000	330000	2800	3600	1.98
97515A1	75	130	74.625	31	62	2	0.5	0.44	1.55	2.3	1.52	295000	463000	2600	3200	3.732
97815Л	75	130	79	37	66	1.8	0.5	0.22	3.07	4.57	3	268000	412000		2400	3.905
97516A	80	140	79.625	33	65	2.5	0.6	0.4	1.68	2.5	1.64	339000	525000	2200	2800	4.574
97818Л	90	140	68	30.5	56	2	0.5	0.41	1.64	2.43	1.62	192000	292000		3000	3.41
97718Л	90	145	84	38	69	2	0.5	0.26	2.58	3.85	2.53	280000	473000		2500	5.6
97218A	90	160	77.25	30	64	2.5	0.6	0.35	1.78	2.54	1.89	357000	536000	1600	2000	5.87
97518A	90	160	95.25	40	78	2.5	0.5	0.42	1.6	2.4	1.57	470000	761000	2000	2600	7.22
97919Л	95	145	84	38	69	1.8	0.5	0.4	1.57	2.55	1.42	280000	471000		2500	5.11
97921P	95	170	47.675	20.638	43	1.5	0.5	0.59	1.14	1.7	1.11	169000	321000	1500	1900	4.785
97920Л**	100	150	92	42	76	2	0.5	0.4	1.56	2.45	1.39	327000	545000		2400	5.26
97520A	100	180	111.25	46	92	3	0.9	0.42	1.6	2.4	1.57	585000	967000	1700	2200	11.07
597820ЛKY	101.6*	165.1*	106.35	49.5	114.3	2	0.9	0.26	2.56	3.8	2.5	421000	783000	2000	2500	10.273
97521A	105	190	117.25	50	96	3	0.9	0.42	1.6	2.4	1.57	629000	1110000	1500	2000	13.47
97822Y	110	180	103	38	84.37	3	0.8	0.46	1.47	2.19	1.44	417000	815000	1500	2000	9.88
97724Л1**	120	180	96.8	44	80.5	2.5	0.6	0.2	2.8	3.9	2.5	364000	668000		2500	8.02
597824MY	120	195	126	57.15	131.35	3	1.1	0.26	2.55	3.8	2.5	668000	1330000	1600	2000	14.624
597826XKM1Y	129.96	230	149.25	71.5	150	4	1.1	0.26	2.55	3.8	2.49	984000	1730000	1300	1600	25.192
597026XMY	129.96	250	149.25	71.5	156.8	4	1.1	0.26	2.55	3.8	2.5	984000	1730000	1300	1600	34.712
597726XMY	129.96	250	149.25	71.5	160	4	1.1	0.26	2.55	3.8	2.5	984000	1730000	1300	1600	35.012
597126XMY	129.96	250	160	71.5	160	4	1.1	0.26	2.55	3.8	2.5	984000	1730000	1300	1600	37.8
2097726KM	130	210	109.25	42	90	2.5	0.6	0.37	1.83	2.7	1.8	501000	951000	1000	1300	13.546