

Spherical Roller Thrust Bearing

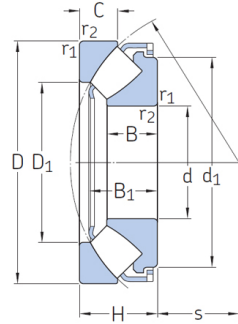

| Designation | Basic Dimensions | | | Basic load ratings | | Fatigue load limit Pu | Minimum load factor A | Speed ratings | | Install dimensions | | | | | | Abutment and illet dimensions | | | | | | | |
|-------------|------------------|-----|-----|--------------------|-----------|-----------------------|-----------------------|-----------------|----------------|--------------------|------|------|------|------|----------|-------------------------------|--------|---------|---------|--------|--------|--------|------|
| | D | H | d | dynamic C | static C0 | | | Reference speed | Limiting speed | d1 ≈ | D1 ≈ | B | B1 | C | r1,2 min | s | da min | db1 max | db2 max | Ha min | Da max | ra max | |
| 29412E | 60 | 130 | 42 | 390 | 915 | 114 | 0.08 | 2800 | 5000 | 112 | 85.5 | 27 | 36.7 | 21 | 1.5 | 38 | 90 | 67 | 67 | - | 107 | 1.5 | 2.6 |
| 29413E | 65 | 140 | 45 | 455 | 1080 | 137 | 0.11 | 2600 | 4800 | 120 | 91.5 | 29.5 | 39.8 | 22 | 2 | 42 | 100 | 72 | 72 | - | 117 | 2 | 3.2 |
| 29414E | 70 | 150 | 48 | 520 | 1250 | 153 | 0.15 | 2400 | 4300 | 129 | 99 | 31 | 41 | 23.8 | 2 | 44.8 | 105 | 77 | 77 | - | 125 | 2 | 3.9 |
| 29415E | 75 | 160 | 51 | 600 | 1430 | 173 | 0.19 | 2400 | 4000 | 138 | 106 | 33.5 | 45.7 | 24.5 | 2 | 47 | 115 | 82 | 82 | - | 133 | 2 | 4.7 |
| 29416E | 80 | 170 | 54 | 670 | 1630 | 193 | 0.25 | 2200 | 3800 | 147 | 113 | 35 | 48.1 | 26.5 | 2.1 | 50 | 120 | 88 | 88 | - | 141 | 2 | 5.6 |
| 29317E | 85 | 150 | 39 | 380 | 1060 | 129 | 0.11 | 2400 | 4000 | 134 | 110 | 24.5 | 33.8 | 20 | 1.5 | 50 | 115 | 90 | 90 | - | 129 | 1.5 | 2.75 |
| 29417E | 85 | 180 | 58 | 735 | 1800 | 212 | 0.31 | 2000 | 3600 | 155 | 121 | 37 | 51.1 | 28 | 2.1 | 54 | 130 | 94 | 94 | - | 151 | 2 | 6.75 |
| 29318E | 90 | 155 | 39 | 400 | 1080 | 132 | 0.11 | 2400 | 4000 | 138 | 115 | 24.5 | 34.5 | 19.5 | 1.5 | 53 | 120 | 95 | 95 | - | 134 | 1.5 | 2.85 |
| 29418E | 90 | 190 | 60 | 815 | 2000 | 232 | 0.38 | 1900 | 3400 | 164 | 128 | 39 | 54 | 28.5 | 2.1 | 56 | 135 | 99 | 99 | - | 158 | 2 | 7.75 |
| 29320E | 100 | 170 | 42 | 465 | 1290 | 156 | 0.16 | 2200 | 3600 | 152 | 128 | 26.2 | 36.3 | 20.5 | 1.5 | 58 | 130 | 107 | 107 | - | 147 | 1.5 | 3.65 |
| 29420E | 100 | 210 | 67 | 980 | 2500 | 275 | 0.59 | 1700 | 3000 | 182 | 142 | 43 | 57.3 | 32 | 3 | 62 | 150 | 110 | 110 | - | 175 | 2.5 | 10.5 |
| 29322E | 110 | 190 | 48 | 610 | 1730 | 204 | 0.28 | 1900 | 3200 | 171 | 140 | 30.3 | 41.7 | 24.8 | 2 | 63.8 | 145 | 117 | 117 | - | 164 | 2 | 5.3 |
| 29422E | 110 | 230 | 73 | 1180 | 3000 | 325 | 0.86 | 1600 | 2800 | 199 | 156 | 47 | 64.7 | 34.7 | 3 | 69 | 165 | 120 | 129 | - | 193 | 2.5 | 13.5 |
| 29324E | 120 | 210 | 54 | 765 | 2120 | 245 | 0.43 | 1700 | 2800 | 188 | 155 | 34 | 48.2 | 27 | 2.1 | 70 | 160 | 128 | 128 | - | 181 | 2 | 7.35 |
| 29424E | 120 | 250 | 78 | 1370 | 3450 | 375 | 1.1 | 1500 | 2600 | 216 | 171 | 50.5 | 70.3 | 36.5 | 4 | 74 | 180 | 132 | 142 | - | 209 | 3 | 17.5 |
| 29326E | 130 | 225 | 58 | 865 | 2500 | 280 | 0.59 | 1600 | 2600 | 203 | 166 | 36.7 | 50.6 | 30.1 | 2.1 | 75.6 | 175 | 138 | 143 | - | 194 | 2 | 9 |
| 29426E | 130 | 270 | 85 | 1560 | 4050 | 430 | 1.6 | 1300 | 2400 | 234 | 185 | 54 | 76 | 40.9 | 4 | 81 | 195 | 142 | 153 | - | 227 | 3 | 22 |
| 29328E | 140 | 240 | 60 | 980 | 2850 | 315 | 0.77 | 1500 | 2600 | 216 | 177 | 38.5 | 54 | 30 | 2.1 | 82 | 185 | 148 | 154 | - | 208 | 2 | 10.5 |
| 29428E | 140 | 280 | 85 | 1630 | 4300 | 455 | 1.8 | 1300 | 2400 | 245 | 195 | 54 | 75.6 | 41 | 4 | 86 | 205 | 153 | 162 | - | 236 | 3 | 23 |
| 29230E | 150 | 215 | 39 | 408 | 1600 | 180 | 0.24 | 1800 | 2800 | 200 | 176 | 24 | 34.3 | 20.5 | 1.5 | 82 | 180 | 154 | 154 | 14 | 193 | 1.5 | 4.3 |
| 29330E | 150 | 250 | 60 | 1000 | 2850 | 315 | 0.77 | 1500 | 2400 | 223 | 190 | 38 | 54.9 | 28 | 2.1 | 87 | 195 | 158 | 163 | - | 219 | 2 | 11 |
| 29430E | 150 | 300 | 90 | 1860 | 5100 | 520 | 2.5 | 1200 | 2200 | 262 | 208 | 58 | 80.8 | 43.4 | 4 | 92 | 220 | 163 | 175 | - | 253 | 3 | 28 |
| 29332E | 160 | 270 | 67 | 1180 | 3450 | 375 | 1.1 | 1300 | 2200 | 243 | 203 | 42 | 60 | 33 | 3 | 92 | 210 | 169 | 176 | - | 235 | 2.5 | 14.5 |
| 29432E | 160 | 320 | 95 | 2080 | 5600 | 570 | 3 | 1100 | 2000 | 279 | 224 | 60.5 | 84.3 | 45.5 | 5 | 99 | 235 | 175 | 189 | - | 270 | 4 | 32 |
| 29334E | 170 | 280 | 67 | 1200 | 3550 | 365 | 1.2 | 1300 | 2200 | 251 | 215 | 42.2 | 61.1 | 30.5 | 3 | 96 | 220 | 178 | 188 | - | 245 | 2.5 | 15 |
| 29434E | 170 | 340 | 103 | 2360 | 6550 | 640 | 4.1 | 1100 | 1900 | 297 | 236 | 65.5 | 91.2 | 50 | 5 | 104 | 250 | 185 | 199 | - | 286 | 4 | 44.5 |
| 29236E | 180 | 250 | 42 | 495 | 2040 | 212 | 0.4 | 1600 | 2600 | 234 | 208 | 26 | 36.9 | 22 | 1.5 | 97 | 210 | 187 | 187 | 14 | 226 | 1.5 | 5.8 |
| 29336E | 180 | 300 | 73 | 1430 | 4300 | 440 | 1.8 | 1200 | 2000 | 270 | 227 | 46 | 66.2 | 35.5 | 3 | 103 | 235 | 189 | 195 | - | 262 | 2.5 | 19.5 |
| 29436E | 180 | 360 | 109 | 2600 | 7350 | 710 | 5.1 | 1000 | 1800 | 315 | 250 | 69.5 | 96.4 | 53 | 5 | 110 | 265 | 196 | 210 | - | 304 | 4 | 52.5 |
| 29338E | 190 | 320 | 78 | 1630 | 4750 | 490 | 2.1 | 1100 | 1900 | 285 | 244 | 49 | 71.3 | 36 | 4 | 110 | 250 | 200 | 211 | - | 280 | 3 | 23.5 |